

# CMW Series Common Mode Inductors

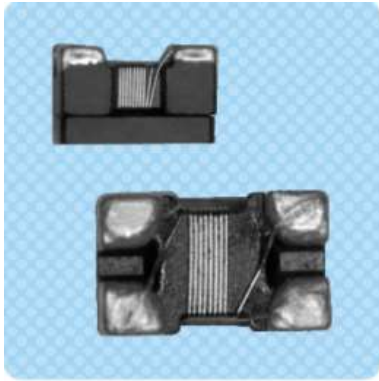

## FEATURES

- ROHS, Halogen free and REACH Compliance
- Miniature SMD type common mode filter for fully automated assembly
- Wide impedance range for noise suppression
- Excellent solderability

## APPLICATIONS

- USB line for personal computers and peripheral.
- IEEE 1394 line for personal computers, DVC, STB
- LVDS, panel line for liquid display panels, graph card, etc.

## SHAPE AND DIMENSIONS

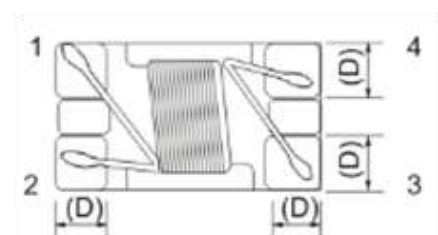
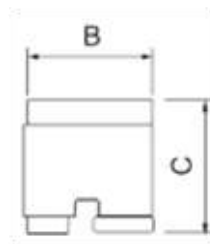
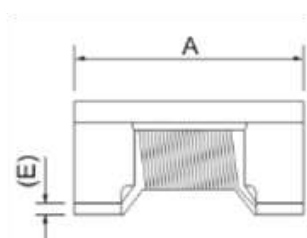

Part Number	Dimensions (mm)				
	A	B	C	D	E
CMW2012	2.0±0.2	1.2±0.2	1.2±0.2	0.4	0.17
CMW3216	3.2±0.2	1.8±0.2	1.8±0.2	0.6	0.17

### RECOMMENDED PC BOARD PATTERN

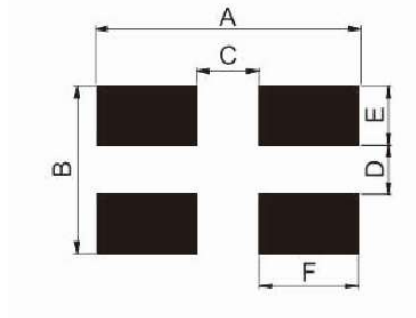

Part Number	Dimensions (mm)					
	A	B	C	D	E	F
CMW2012	2.3	1.7	0.8	0.3	0.5	0.75
CMW3216	3.8	2.0	1.8	0.4	0.8	1.0

### PRODUCT IDENTIFICATION

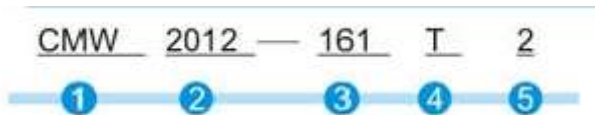

- 1 Series name
- 2 Dimensions L×W
- 3 Impenance: 100-10Ω 161-160Ω
- 4 Type: D-Unshielded T-Shielded
- 5 Circuit Number: 2-2 cicuit line

## SPECIFICATIONS

### ● CMW2012 TYPE

Part Number	Impenance (Ω)	Tolerance	Test Frequency (MHz/V)	DCR Max(Ω)	Irms Max(mA)	Withstand Voltage(V)	Insulation Resistance Min (mΩ)
CMW2012-670-T2	67	±25%	100	0.25	400	50	10
CMW2012-900-T2	90			0.35	400		
CMW2012-121-T2	120			0.35	400		
CMW2012-161-T2	160			0.35	350		
CMW2012-181-T2	180			0.35	330		
CMW2012-221-T2	220			0.38	300		
CMW2012-261-T2	260			0.40	300		
CMW2012-371-T2	360			0.40	280		

### ● CMW3216TYPE

Part Number	Impenance (Ω)	Tolerance	Test Frequency (MHz/V)	DCR Max(Ω)	Irms Max(mA)	Withstand Voltage(V)	Insulation Resistance Min (mΩ)
CMW3216-900-T2	90	±25%	100	0.30	400	50	10
CMW3216-161-T2	160			0.40	350		
CMW3216-221-T2	220			0.45	310		
CMW3216-261-T2	260			0.50	310		
CMW3216-601-T2	600			0.80	260		
CMW3216-102-T2	1000			1.00	230		
CMW3216-222-T2	2200			1.20	200		



Specifications subject to change without notice. Please check our website for latest information.

Tel: 0086-769-85016697 Fax: 0086-769-85016658 E-Mail: sales@ZXcompo.com www.zxcompo.com

# DETAIL ELECTRICAL CHARACTERISTICS

## ● CMW 2012 Type

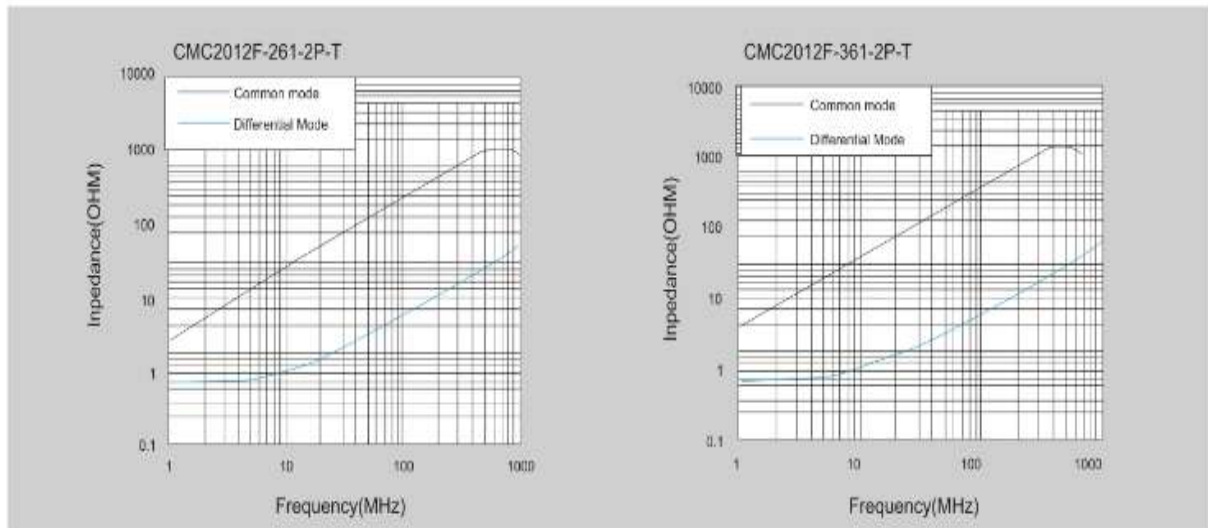
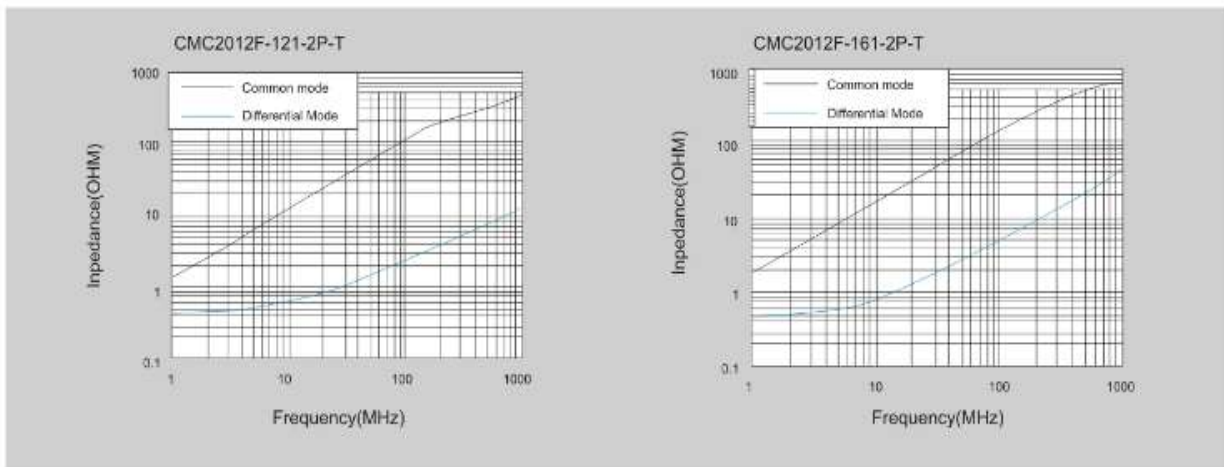
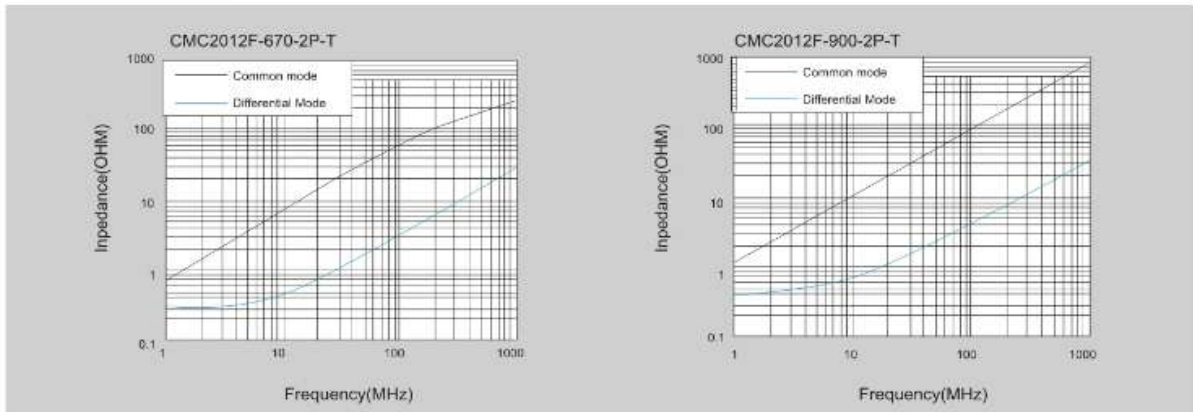

## ● CMW 3216 系列

